



OERTLI

Excellence in solid wood



**Tools for
timber
construction
Catalogue**

Faster – more valuable – Cleaner

The most economical solution for your woodworking

OERTLI tools seem to be expensive. But if you value the highest productivity, minimal processing time and highest reproducible surface quality of your woodworking, then we offer you the best price-performance ratio. You are a company and therefore need to think economically. With over 90 years of experience in the processing of solid wood, we know what matters when it comes to woodworking.

High delivery quality

The right tool in the desired quality - globally tried-and-tested solid carbide shank cutters

With OERTLI, you can choose from a comprehensive stock range at any time. For standard solutions we guarantee the shortest delivery times and can provide the quality you require.

It is hard to imagine high-quality timber technology without OERTLI tools. They are renowned worldwide for their high performance with above-average service lives.

Individual solutions According to your requirements

For extraordinary challenges in timber construction, we produce individual tool solutions according to your requirements. With the help of the latest production systems and the knowledge of our experts, our tools demonstrate the highest possible precision. This is what OERTLI is known for – worldwide.

For over 90 years, we have remained loyal to our high quality Swiss standards and continuously work on new innovations for the success of our customers.

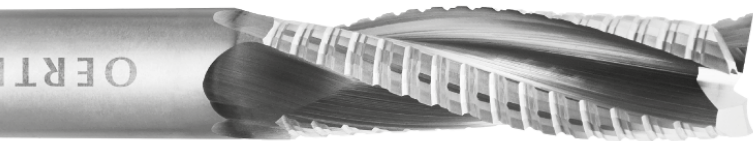



Minimal cutting pressure Highest efficiency in woodworking with reversible knife technology

OERTLI has a leading position in the development and decades-long experience in the area of reversible knife technology. This guarantees an economically sustainable product. Thanks to low maintenance costs and times, as well as an excellent price/performance ratio, the use of OERTLI reversible knife tools offer an important competitive factor for every timber construction company.

OERTLI employees will be happy to advise you on the use of reversible knives and will develop the optimal tool solution for you based on this technology.

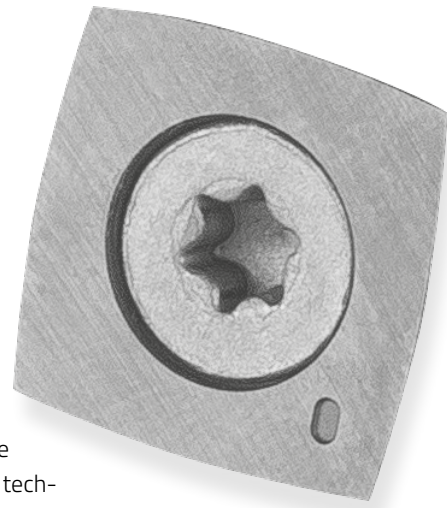

Maximum precision Sturdy and dimensionally stable cut

OERTLI circular saw blades for longitudinal, chop, transverse and compound mitre cutting are specially designed for the **high demands of CNC joinery machines**.

The steel blade of the highest quality guarantees a **sturdy and dimensionally stable cut with excellent cut quality**.

The extremely wear-resistant carbide tips are designed to meet the demands of timber construction and offer considerably **longer tool lifetimes than comparable saw blades**.

Thanks to their low noise levels, OERTLI saw blades help to maintain a pleasant production environment and for this reason alone are popular for use in timber construction production factories.



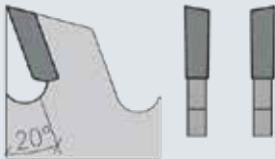
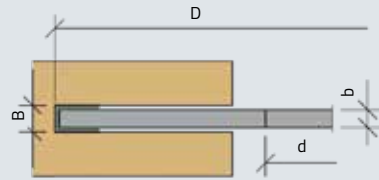
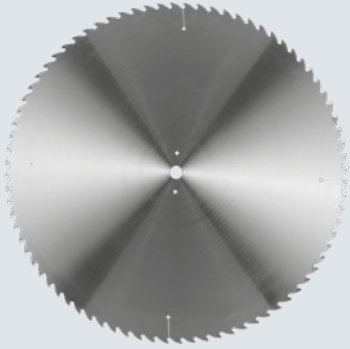

OERTLI Premium HW saw

Application

- Cutting along and across the grain and compound mitre cut
- Soft and hard woods, laminated beams and solid wood panels

Machine

- CNC joinery machines and carpentry machine
- 5-axis machining centres with HSK holder

Design

- Special saw for highest demands
- Extremely stable basic body
- Quiet and virtually vibration-free

Your benefits

- Sturdy cut, even with a large cutting height
- Quiet operation and best cutting quality
- Longer tool lifetime

Art. No.	D	B	b	d	NL	Z
✓ TB750300	500	5.2	3.4	30		36 WZ
✓ TB750305	720	6.0	4.4	30	8/9/120 + 4/9/90 + 2/14/400	54 WZ
✓ TB750307	760	6.0	4.4	30	2/14/400 + 4/9/90	50 WZ
✓ TB750310	800	6.0	4.4	30	8/9/160 + 2/14/400 + 4/9/90	48 WZ
✓ TB750311	800	6.0	4.4	30	2/14/400 + 4/9/90	60 WZ
✓ TB750312	800	6.0	4.4	30	2/14/400 + 4/9/90	80 WZ

OERTLI Standard HW saw

Application

- Cutting along and across the grain and compound mitre cut
- Soft and hard woods, laminated beams and solid wood panels

Machine

- CNC joinery machines and carpentry machine
- 5-axis machining centres with HSK holder

Design

- Universal saw for timber construction
- Stable basic body

Your benefits

- Sturdy cut, even with a large cutting height
- Quiet operation and best cutting quality

Art. No.	D	B	b	d	NL	Z	Compatible with
✓ TA756525	500	4.0	2.8	30	2/4/42+2/9/46 +2/10/60	44 WZ	
✓ TB750362	500	4.2	2.8	30	2/4/42+2/9/46.5+2/10/60	32 FZ+4	
● TA758610	500	5.2	3.8	30	2/10/80	72 WZ	
● TA758613	550	5.2	3.8	30	2/10/80	84 WZ	
● TC104800	555	5.2	3.6	55	6.0/6.6/75	54 WZ+2+2	Weinmann
● TB750363	600	5.2	3.8	30	2/10/80+2/15/63	72 WZ	
● TC104801	640	5.4	3.6	30	2/7/42/+2/9/46.5+2/10/60	36 FZ+2+2	Mafell
● TB750366	650	5.9	4.2	30	2/10/80+2/15/63	100 WZ	
● TB750350	700	6.0	4.2	30	2/10/80 + 2/15/63	60 WZ	Krüsi
● TB750351	700	6.0	4.2	30	2/18/100	84 WZ	
● TB750352	700	6.5	4.4	30		110 WZ	
● TB750353	720	6.0	4.4	30	2/8.5/90	72 WZ	Hundegger
● TB750354	735	6.0	4.4	30	2/8.5/90	48 WZ+2+2	Hundegger
● TB750356	750	6.5	4.5	40	2/10.5/60	48 WZ+2+2	Schneider
● TB750357	750	6.5	4.5	40	2/10.5/60	60 WZ	
● TB750358	750	6.8	5.0	30		60 WZ	Krüsi
● TB750359	750	7.0	4.8	60	2/12.5/240	120 WZ	Springer
● TB750360	760	6.0	4.4	30	4/8.5/90 + 2/14/400	72 WZ	Hundegger
● TB750364	800	6.0	4.4	30	2/14/400+4/8.3/90+8/M8/160	48 WZ+2+2+2	
● TB750365	800	6.0	4.4	30	2/14/400+4/8.5/90	80 WZ	
● TB750361	800	7.0	5.0	30	4/8.5/90 + 2/14/400	80 WZ	Hundegger
✓ TB750367	1000	6.2	4.5	40	8/9/200 mit Senkung	80 WZ	Technowood

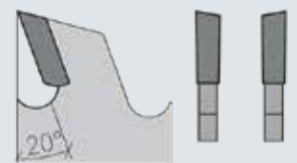
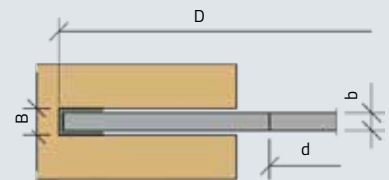
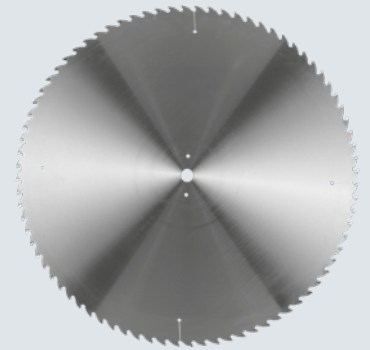

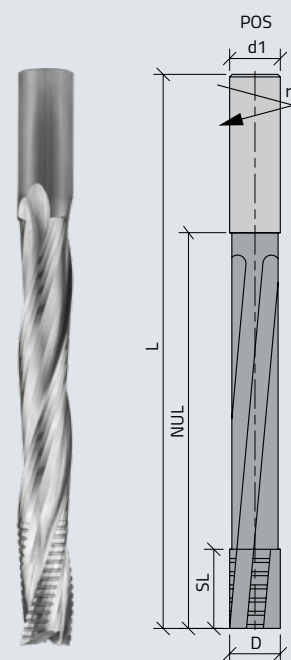
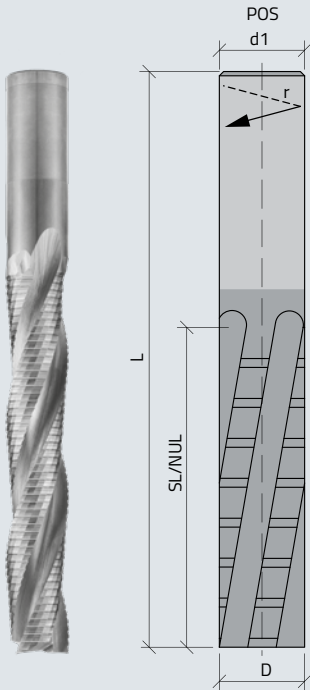

TURBEX SPRINT Finish

Application

- For separating, formatting, grooving and drill milling
- Soft- and hardwood, glue laminated timber, wood board
- Excellently suitable for construction beech
- „Roughing/finishing“ combination for best surface quality

Machine

- CNC joinery systems
- Portal machining systems

Design

- Solid tungsten carbide (VHM)
- Centre cutting edge
- Short and long version depending on milling depth
- Shrink fit or offset shank for collet ER 40

Your benefits

- Time saving and higher quality
- Higher feed rate than roughing or Finishing cutter single
- Roughing and finishing in one work step
- Long service life in soft, hard or glued timbers

Art. No.	D	SL	NUL	L	d1	Z	DW	DR	Compatible with
✓ TB680010	12	45	45	90	12	3	pos.	re.	
✓ TB680011	16	55	55	110	16	3	pos.	re.	
✓ TB680012	20	55	55	115	20	3	pos.	re.	
✓ TB680013	20	75	75	135	20	3	pos.	re.	
✓ TB680071	20	35	135	190	20	3	pos.	re.	
• TB680070	20	135	135	190	20	3	pos.	re.	
✓ TB680073	20	35	175	230	20	3	pos.	re.	
• TB680072	20	175	175	230	20	3	pos.	re.	
✓ TB680074	25	35	130	190	25	3	pos.	re.	
• TB680075	25	130	130	190	25	3	pos.	re.	
✓ TB680077	25	35	170	230	25	3	pos.	re.	
• TB680076	25	170	170	230	25	3	pos.	re.	
✓ TB680079	25	35	190	250	25	3	pos.	re.	
• TB680078	25	190	190	250	25	3	pos.	re.	
• TB680080	30	50	120	195	30/29.8	3	pos.	re.	Hundegger
✓ TB680081	30	120	120	195	30/29.8	3	pos.	re.	Hundegger
• TB680082	30	50	120	190	30	3	pos.	re.	
✓ TB680083	30	120	120	190	30	3	pos.	re.	
• TB680084	30	50	160	237.5	30/29.8	3	pos.	re.	Hundegger
✓ TB680085	30	160	160	237.5	30/29.8	3	pos.	re.	Hundegger
• TB680086	30	50	180	250	30	3	pos.	re.	
✓ TB680087	30	180	180	250	30	3	pos.	re.	
✓ TB680088	30	50	220	290	30	3	pos.	re.	
✓ TB680089	30	220	220	290	30	3	pos.	re.	
• TB680092	40	60	110	190	40	3	pos.	re.	
• TB680093	40	110	110	190	40	3	pos.	re.	

Art. No.	D	SL	NUL	L	d1	Z	DW	DR	Compatible with
● TB680090	40	60	120	190	30/29.8	3	pos.	re.	Hundegger
✓ TB680091	40	120	120	190	30/29.8	3	pos.	re.	Hundegger
✓ TB680101	40	120	120	190	30	3	pos.	re.	
● TB680094	40	60	163.5	237.5	30/29.8	3	pos.	re.	Hundegger
✓ TB680095	40	163.5	163.5	237.5	30/29.8	3	pos.	re.	Hundegger
✓ TB680096	40	60	170	250	40	3	pos.	re.	
● TB680098	40	170	170	250	40	3	pos.	re.	
✓ TB680102	40	60	180	250	30	3	pos.	re.	
✓ TB680103	40	180	180	250	30	3	pos.	re.	
✓ TB680099	40	60	250	330	40	3	pos.	re.	
● TB680100	40	250	250	330	40	3	pos.	re.	

TURBEX Rough-finishing cutters HS

Application

- For separating, formatting, grooving and drill milling
- Soft and hard woods and solid wood panels
- „Roughing/finishing“ combination for best surface quality

Machine

- CNC joinery systems

Design

- HS-massiv
- Centre cutting edge
- Short and long version depending on milling depth
- Shank for shrinking or set-off for collet ER 40

Your benefits

- Time saving and higher quality
- Higher feed rate than with roughing or finishing cutter single
- Better surface finish than with rough milling cutter
- Roughing and finishing in one work step

Art. No.	D	SL	NUL	L	d1	Z	DW	DR	Compatible with
✓ TB680754	25	140	140	200	25	3	pos.	re.	
✓ TB680755	30	140	140	210	30	3	pos.	re.	
✓ TB680750	40	120	120	190	30/29.8	3	pos.	re.	Hundegger
✓ TB680752	40	120	120	190	30	3	pos.	re.	
✓ TB680751	40	160	160	230	30/29.8	3	pos.	re.	Hundegger
✓ TB680753	40	160	160	230	30	3	pos.	re.	

- ✓ Ex stock, subject to the goods being unsold
- According to frame schedule

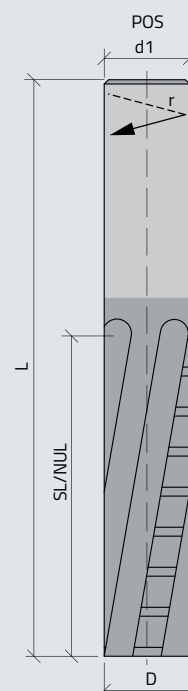

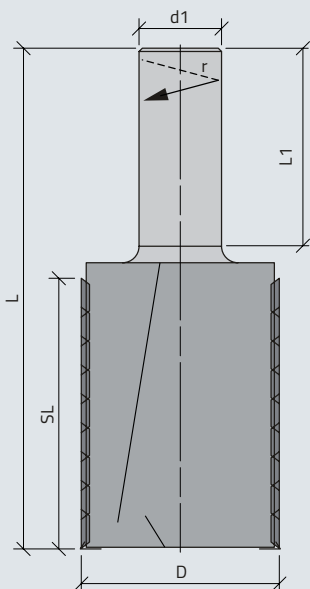

CASTOR Drill- Universal milling cutter

Application

- For drill milling, cutting out, formatting, grooving
- Soft and hard woods, laminated beams, cross laminated timber boards
- For circular drill milling
- Chip removal by large chip flow area

Machine

- CNC joinery systems
- Portal machining systems

Design

- With standard cutting edges
- Centre cutting edge for drill milling
- Short and long version depending on milling depth
- From SL 100, milling cutter made of Aluminium, shank made of hardened steel
- Shrinkable shaft
- Very long working length due to appropriate clamping device
- Optimized cutting division

Your benefits

- Time saving due to fewer tool changes
- One tool for different machining operation
- Increased productivity due to higher feed rate
- Extensive stock program

Art. No.	Type	D	SL	L1	L	d1	Z	DW	DR	n max	Index
✓ TB860115	Steel	45	50	98	150	20	Z-Basis 2+1	pos.	re.	22200	1,2,4,5
✓ TB860114	Steel	45	80	68	150	20	Z-Basis 2+1	pos.	re.	22500	1,2,4,5
✓ TB860117	Steel	50	50	98	150	20	Z-Basis 2+1	pos.	re.	19600	1,4,7
✓ TB860116	Steel	50	80	68	150	20	Z-Basis 2+1	pos.	re.	20000	1,4,7
✓ TB860110	Steel	61	50	58	110	25	Z-Basis 2+1	pos.	re.	24000	1,2,3,4,5,6
✓ TB860113	Steel	61	50	143	195	30	Z-Basis 2+1	pos.	re.	20300	1,2,3,4,5,6
● TB860112	Steel/Alu	61	100	60	162	30	Z-Basis 2+1	pos.	re.	22000	1,2,3,4,5,6
● TB860130	Steel/Alu	61	130	60	192	30	Z-Basis 2+1	pos.	re.	22000	1,2,3,4,5,6
✓ TB860111	Steel/Alu	61	175	60	237	30	Z-Basis 2+1	pos.	re.	22000	1,2,3,4,5,6
✓ TB860121	Steel	80	50	143	195	30	Z-Basis 2+1	pos.	re.	14800	1,3,4,6,29
● TB860120	Steel/Alu	80	100	60	162	30	Z-Basis 2+1	pos.	re.	20000	1,3,4,6,29
● TB860119	Steel/Alu	80	130	60	192	30	Z-Basis 2+1	pos.	re.	20000	1,3,4,6,29
✓ TB860118	Steel/Alu	80	165	60	227	30	Z-Basis 2+1	pos.	re.	18200	1,3,4,6,29
✓ TB860136	Steel/Alu	80	210	80	292	40	Z-Basis 2+1	pos.	re.	20000	1,3,4,6,29
● TB860138	Steel/Alu	100	195	80	277	40	Z-Basis 2+1	pos.	re.	16200	1,3,4,6

Spare parts

Art. No.	Detail	Term	Index
KF220017	Cutting edge circumference	13.8 x 13.8 x 2.5	1
KF216009	Cutting edge face side	14 x 14 x 2	2
KF216013	Cutting edge face side	16 x 16 x 3 W11	3
KF216672	Cutting edge face side	15 x 15 x 2.5 R=50	7
TAB51040	Screw for KF220017	M5 x 15.5 Torx 15	4
TAB51038	Screw for KF216009	M5 x 6.3 Torx 15	5
TAB51032	Screw for KF216013	M5 x 11 Torx 15	6
TAB51037	Screw for KF220017 face side	M5 x 10.5 Torx 15	29

Index: Reference number for allocation of the spare parts

CASTOR Sockets drill cutters with chamfer

Application

- For drill milling of socket holes
- Soft and hard woods, glued laminated beams, wood and board materials as well as plasterboard
- Simple quality with minimal tactile and visible traces
- For circular drill milling

Machine

- CNC joinery systems
- Portal processing plants for the prefabricated house construction

Design

- With standard cutting edges
- Centre cutting edge for drill milling
- Shrinkable shaft
- Very long working length due to appropriate clamping device

Your benefits

- Low cutting pressure due to large cutting division
- Drilling and chamfering 2x45° in the same work step
- Increased productivity through higher feed rates
- No rework necessary
- Increased productivity through simultaneous drilling and chamfering of the hole edge

Art. No.	Type	D	SL	L1	L	d1	Z	DW	DR	n max	Index
✓ TB860150	Steel	62/69	55	50	126	25	Z-Basis 2+1	pos.	re.	22000	1,2,3,4,5,6

Spare parts

Art. No.	Detail	Term	Index
KF220017	Cutting edge circumference	13.8 x 13.8 x 2.5	1
KF216009	Cutting edge face side	14 x 14 x 2	2
KF216013	Cutting edge face side	16 x 16 x 3 W11	3
TA851040	Screw for KF220017	M5 x 15.5 Torx 15	4
TA851038	Screw for KF216009	M5 x 6.3 Torx 15	5
TA851032	Screw for KF216013	M5 x 11 Torx 15	6

Index: Reference number for allocation of the spare parts

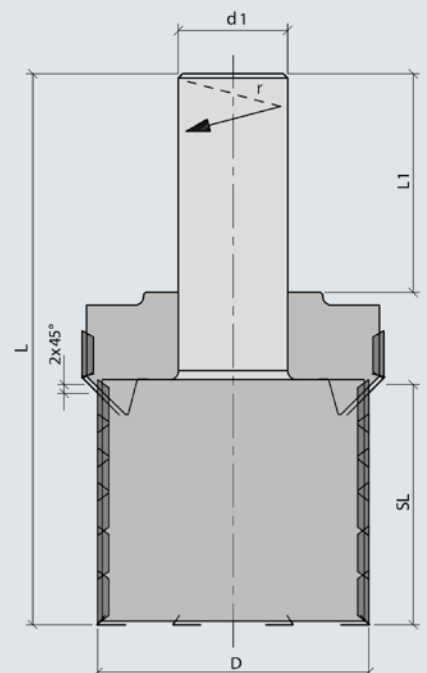

- ✓ Ex stock, subject to the goods being unsold
- According to frame schedule

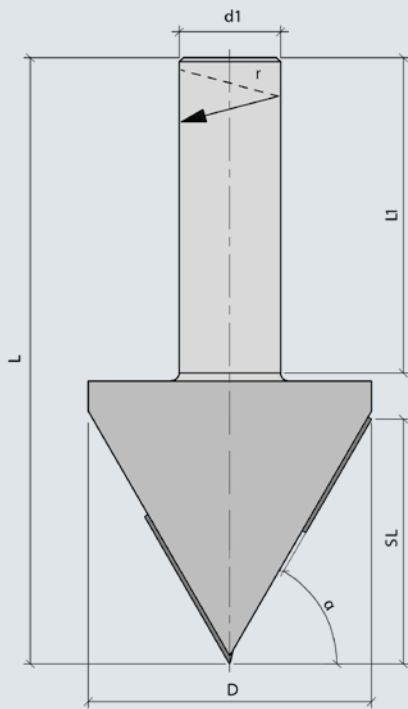

HW Sharpening cutter

Application

- For pointing and finishing the corners of cut-outs
- Soft and hard woods, laminated beams, cross laminated timber boards

Machine

- 5-axis CNC joinery systems
- 5-axis CNC portal machining systems

Design

- HW assembled
- Cutting point running out into the centre
- Re-sharpenable cutting edge
- Shrinkable shaft

Your benefits

- Large diameter and long cutting length
- Even larger radii can be sharpened
- Long milling cutter for deep cut-outs

Art. No.	Type	D	SL	L1	L	d1	Z	DW	DR	alpha	n max
✓ TB681024	Steel	70	60	78	150	25	1+1	pos.	re.	60°	18000

CASTOR Rebating- and finish jointing

Application

- For rebating, joining, formatting and grooving
- Soft and hard woods, laminated beams, cross laminated timber boards

Machine

- CNC joinery systems
- Portal machining systems

Design

- With standard reversible cutting
- Face cutting edge for rebating
- Negative twist for tear-free upper edge

- Short and long version depending on milling depth
- From SL 100, milling cutter made of Aluminium, shank made of toughened steel
- Shrinkable shaft
- Very long working length due to appropriate clamping device

Your benefits

- Time saving due to few tool changes
- One tool for different machining operations
- Increased productivity due to higher feed rate
- Extensive stock program

Art. No.	Type	D	SL	L1	L	d1	Z	DW	DR	n max	Index
✓ TB860107	Steel	45	80	58	144	20	Z-Basis 2+2	neg.	re.	24000	1,2,4,5
✓ TB860102	Steel	60	82	58	147	25	Z-Basis 2+2	neg.	re.	24000	1,2,4,5
● TB860131	Steel/Alu	60	130	60	197	30	Z-Basis 2+2	neg.	re.	24000	1,4
✓ TB860132	Steel/Alu	60	170	60	237	30	Z-Basis 2+2	neg.	re.	22500	1,4
● TB860133	Steel/Alu	80	100	60	168	30	Z-Basis 2+2	neg.	re.	20000	1,4
● TB860134	Steel/Alu	80	130	60	198	30	Z-Basis 2+2	neg.	re.	20000	1,4
● TB860135	Steel/Alu	80	160	60	228	30	Z-Basis 2+2	neg.	re.	18200	1,4
✓ TB860137	Steel/Alu	80	210	80	291	40	Z-Basis 2+2	Zero	re.	20000	1,4
● TB860139	Steel/Alu	100	195	80	276	40	Z-Basis 2+2	Zero	re.	16200	1,4

Spare parts

Art. No.	Detail	Term	Index
KF220017	Cutting edge circumference	13.8 x 13.8 x 2.5	1
KF220017	Cutting edge face side	13.8 x 13.8 x 2.5	1
KF216009	Cutting edge face side	14 x 14 x 2	2
TAB51040	Screw for KF220017	M5 x 15.5 Torx 15	4
TAB51038	Screw for KF216009	M5 x 6.3 Torx 15	5

Index: Reference number for allocation of the spare parts

- ✓ Ex stock, subject to the goods being unsold
- According to frame schedule

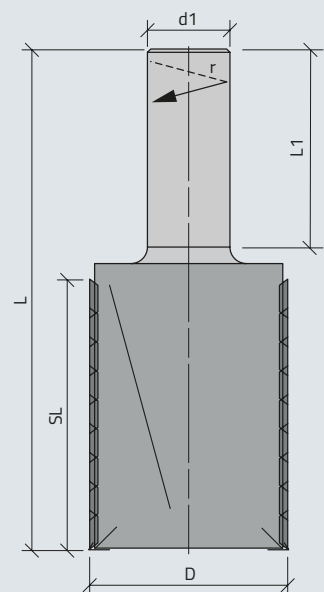
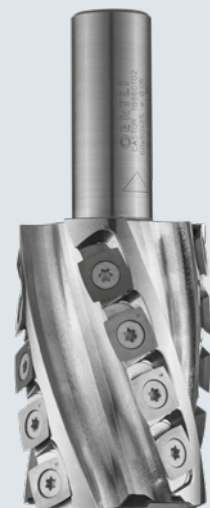

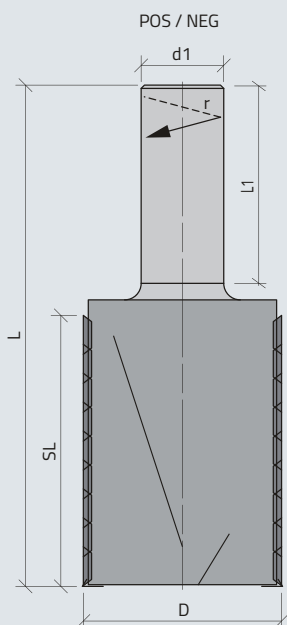
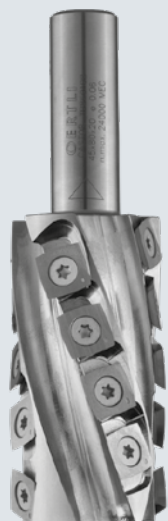

CASTOR Rebating cutter

Application

- For joining and formatting
- Soft and hard woods, laminated beams, Cross laminated timber

Machine

- CNC joinery systems
- Portal machining systems

Design

- With standard reversible cutting
- Without end cutting edge
- With alternating twist for tear-free edges
- Short and long version depending on panel thickness
- From SL 100, milling cutter made of Aluminium, shank made of hardened steel
- Very long working length due to appropriate clamping devices

Your benefits

- Top quality on the upper and lower edge due to own cutting geometry
- Increased productivity due to higher feed rate
- Extensive stock program

Art. No.	Type	D	SL	L1	L	d1	Z	DW	DR	n max	Index
✓ TB860108	Steel	45	80	58	148	20	Z-Basis 2	pos. / neg.	re.	24000	1,4
● TB860122	Steel	60	80	58	150	25	Z-Basis 2	pos. / neg.	re.	24000	1,4
● TB860123	Steel/Alu	60	130	60	202	30	Z-Basis 2	pos. / neg.	re.	24000	1,4
● TB860124	Steel/Alu	60	165	60	237	30	Z-Basis 2	pos. / neg.	re.	22400	1,4
● TB860125	Steel/Alu	80	100	60	173	30	Z-Basis 2	pos. / neg.	re.	20000	1,4
● TB860126	Steel/Alu	80	130	60	203	30	Z-Basis 2	pos. / neg.	re.	20000	1,4
● TB860127	Steel/Alu	80	155	60	228	30	Z-Basis 2	pos. / neg.	re.	18100	1,4

Spare parts

Art. No.	Detail	Term	Index
KF220017	Cutting edge circumference	13.8 x 13.8 x 2.5	1
TA851040	Screw for KF220017	M5 x 15.5 Torx 15	4

Index: Reference number for allocation of the spare parts

Dovetail cutter 15°

Application

- Dovetail Joint
- Soft and hard woods, laminated beams, wood and board materials

Machine

- CNC joinery systems
- Portal machining systems

Design

- With HW profile knives
- Face cutting
- n max. 12000 rpm

Your benefits

- Constant dimension
- No dimensional corrections through regrinding

Art. No.	Type	D	SL	L	d1	Z	DR	Index
● TB680770	Finishing	60	28	55.5	28/16	3	li.	13,25,27
● TB680771	Roughing	60	28	56.5	28/16	3	li.	14,15,16,25,27
● TB680772	Roughing-Finishing	60	28	57.5	28/16	3	li.	17,18,19,25,27
● TB680773	Finishing	65	38	65.5	28/16	3	li.	24,25,27
● TB680776	Finishing	60	28	131	30/29.8	3	re.	20,26,28
● TB680777	Roughing-Finishing	60	28	131	30/29.8	3	re.	21,22,23,26,28

Spare parts

Art. No.	Term	Index
KX100758	Profile knife B=38 h=16.7 a=2	13
KX100759	Profile knife Spindle edge B=38 h=16.7 a=2, Type 1	14
KX100760	Profile knife Spindle edge B=38 h=16.7 a=2, Type 2	15
KX100761	Profile knife Spindle edge B=38 h=16.7 a=2, Type 3	16
KX100762	Profile knife Chip breaker groove B=38 h=16.7 a=2, Type 1	17
KX100763	Profile knife Chip breaker groove B=38 h=16.7 a=2, Type 2	18
KX100764	Profile knife Chip breaker groove B=38 h=16.7 a=2, Type 3	19
KX100765	Profile knife B=50 h=21.5 a=2	20
KX100668	Profile knife Chip breaker groove B=50 h=21.5 a=2, Type 1	21
KX100669	Profile knife Chip breaker groove B=50 h=21.5 a=2, Type 2	22
KX100670	Profile knife Chip breaker groove B=50 h=21.5 a=2, Type 3	23
KX100766	Profile knife B=48 h=16 a=2	24
TB851044	Stop plate D=66 mm für Form A	25
TB851046	Stop plate D=62 mm für Form B	26
TB851045	Fillister head screw M 4 x 5,5, T15	27
TB851047	Fillister head screw M 4 x 5,9, Grosskopf T15	28

Index: Reference number for allocation of the spare parts

- ✓ Ex stock, subject to the goods being unsold
- According to frame schedule

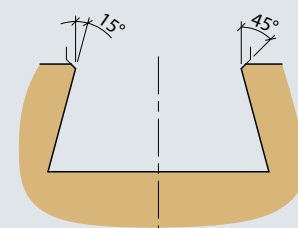
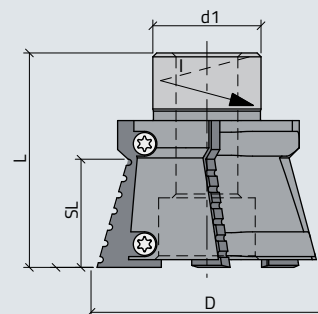
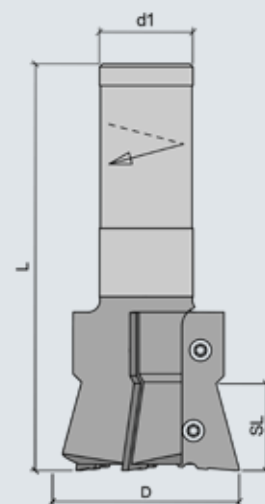
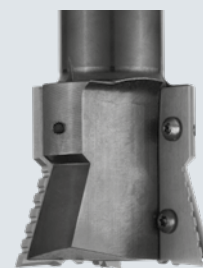

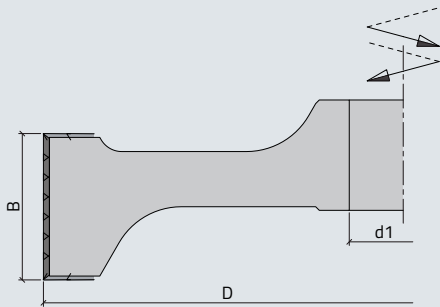

Birdsmouth cutter und grooving cutter

Application

- For chamfering, rebating, grooving and flattening
- Soft and hard woods, laminated beams
- Along, cross and diagonal
- Finishing quality with minimal feel and obvious traces

Machine

- CNC joinery systems
- Portal machining systems

Design

- Same cutting edge type for pre-cutting and circumferential cutting
- Lateral cutting also for deep machining
- Optimized chip spaces for trouble-free Chip discharge and ejection
- Reduced cutting pressure due to optimized cutting division

Your benefits

- Increased productivity due to higher feed rate
- Time saving due to fewer tool changes
- One tool for many machining operations
- Extensive stock program
- Simple and time-saving handling thanks to one Typee of blade

Art. No.	Type	D	B	d	Z-Basis	DR	Tool body	Compatible with	Index	
• TB860312	OPTIMO	250	61	45	DKN	3	re.	Alu	Hundegger	1,4
• TB860315	OPTIMO	250	61	45	DKN	3	li.	Alu	Hundegger	1,4
• TB860311	OPTIMO	250	80	45	DKN	3	re.	Alu	Hundegger	1,4
• TB860314	OPTIMO	250	80	45	DKN	3	li.	Alu	Hundegger	1,4
• TB860310	OPTIMO	250	100	45	DKN	3	re.	Alu	Hundegger	1,4
• TB860313	OPTIMO	250	100	45	DKN	3	li.	Alu	Hundegger	1,4
• TB860318	WIN	300	8	50	NL	3	re.	Steel		7,8,9, 10,11,12
• TB860317	WIN	300	10	50	NL	3	re.	Steel		7,8,9, 10,11,12
• TB860400	SPRINT	300	20	50	NL	3	re.	Alu		1,4
• TB860316	OPTIMO	300	41	50	NL	3	re.	Alu		1,4
✓ TB860343	OPTIMO	300	60	35	NL	3	sym.	Alu	Hundegger/ SCM/Biesse usw.	1,4
• TB860302	OPTIMO	300	60	45	DKN	3	re.	Alu	Hundegger	1,4
✓ TB860344	OPTIMO	300	61	35	NL	3	sym.	Alu	Hundegger/SCM/ Biesse usw.	1,4
• TB860303	OPTIMO	300	61	45	DKN	3	re.	Alu	Hundegger	1,4
• TB860306	OPTIMO	300	61	45	DKN	3	li.	Alu	Hundegger	1,4

Art. No.	Type	D	B	d	Z-Basis	DR	Tool body	Compatible with	Index
✓ TB860309	OPTIMO	300	61	50	NL	3	sym. Alu	Hundegger/ SCM/Biesse usw.	1,4
✓ TB860342	OPTIMO	300	80	35	NL	3	sym. Alu	Hundegger/ SCM/Biesse usw.	1,4
• TB860301	OPTIMO	300	80	45	DKN	3	re. Alu	Hundegger	1,4
• TB860305	OPTIMO	300	80	45	DKN	3	li. Alu	Hundegger	1,4
✓ TB860308	OPTIMO	300	80	50	NL	3	sym. Alu	Hundegger/ SCM/Biesse usw.	1,4
✓ TB860341	OPTIMO	300	100	35	NL	3	sym. Alu	Hundegger/ SCM/Biesse usw.	1,4
• TB860300	OPTIMO	300	100	45	DKN	3	re. Alu	Hundegger	1,4
• TB860304	OPTIMO	300	100	45	DKN	3	li. Alu	Hundegger	1,4
✓ TB860307	OPTIMO	300	100	50	NL	3	sym. Alu	Hundegger/ SCM/Biesse usw.	1,4
• TB860329	WIN	350	8	50	NL	3	re. Steel		7,8,9, 10,11,12
• TB860328	WIN	350	10	50	NL	3	re. Steel		7,8,9, 10,11,12
• TB860401	SPRINT	350	20	50	NL	3	re. Alu		7,8,9, 10,11,12
• TB860327	OPTIMO	350	41	50	NL	3	re. Alu		1,4
✓ TB860339	OPTIMO	350	60	35	NL	3	sym. Alu	Hundegger/SCM/ Biesse usw.	1,4
• TB860321	OPTIMO	350	60	55	DKN	3	re. Alu	Hundegger	1,4
• TB860325	OPTIMO	350	60	55	DKN	3	li. Alu	Hundegger	1,4
✓ TB860340	OPTIMO	350	61	35	NL	3	sym. Alu	Hundegger/SCM/ Biesse usw.	1,4
• TB860322	OPTIMO	350	61	55	DKN	3	re. Alu	Hundegger	1,4
• TB860326	OPTIMO	350	61	55	DKN	3	li. Alu	Hundegger	1,4
✓ TB860338	OPTIMO	350	80	35	NL	3	sym. Alu	Hundegger/SCM/ Biesse usw.	1,4
• TB860320	OPTIMO	350	80	55	DKN	3	re. Alu	Hundegger	1,4
• TB860324	OPTIMO	350	80	55	DKN	3	li. Alu	Hundegger	1,4
✓ TB860337	OPTIMO	350	100	35	NL	3	sym. Alu	Hundegger/SCM/ Biesse usw.	1,4
• TB860319	OPTIMO	350	100	55	DKN	3	re. Alu	Hundegger	1,4

- ✓ Ex stock, subject to the goods being unsold
- According to frame schedule

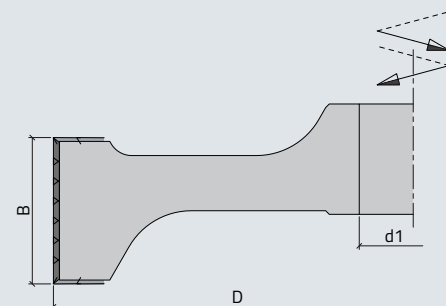

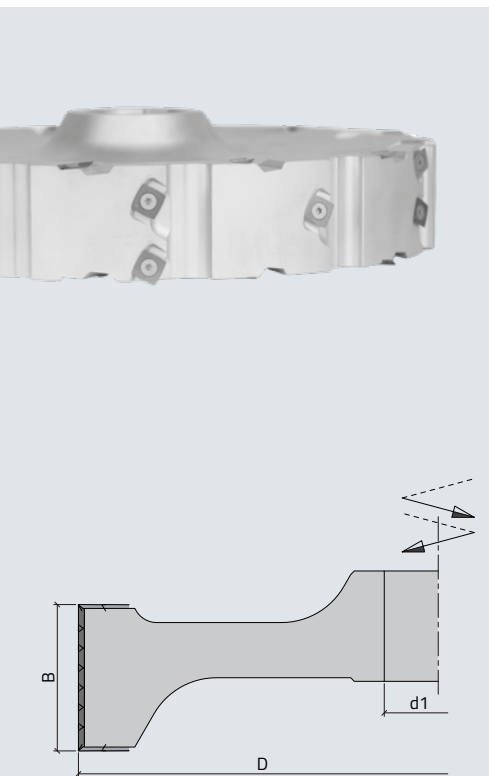

Art. No.	Type	D	B	d	Z-Basis	DR	Tool body	Compatible with	Index	
• TB860323	OPTIMO	350	100	55	DKN	3	li.	Alu	Hundegger	1,4
• TB860332	OPTIMO	370	61	50	DKN	3	re.	Alu	Hundegger	1,4
✓ TB860333	OPTIMO	370	61	50	DKN	3	li.	Alu	Hundegger	1,4
• TB860331	OPTIMO	370	80	50	DKN	3	re.	Alu	Hundegger	1,4
• TB860352	OPTIMO	370	100	50	DKN	3	li.	Alu	Hundegger	1,4
• TB860330	OPTIMO	370	100	50	DKN	3	re.	Alu	Hundegger	1,4
• TB860353	OPTIMO	370	80	50	DKN	3	li.	Alu	Hundegger	1,4
• TB860336	WIN	380	8	50	NL	3	re.	Steel		7,8,9, 10,11,12
• TB860335	WIN	380	10	50	NL	3	re.	Steel		7,8,9, 10,11,12
• TB860402	SPRINT	380	20	50	NL	3	re.	Alu		1,4
• TB860334	OPTIMO	380	41	50	NL	3	re.	Alu		1,4

Spare parts

Art. No.	Detail	Term	Index
KF220017	Cutting edge circumference / face side	13.8 x 13.8 x 2.5	1
KW199001	Cutting edge circumference	WIN Cutting edge	7
KW199002	Cutting edge circumference	WIN Cutting edge	8
TA851040	Screw circumference / face side	M5 x 15.5 Torx 15	4
TA851340	Screw circumference	M5 x 18 Torx 10	9
TB100228	Flange	DR=re. Steel d1=50	10
TA851016	Screw flange	M6 x 12 ISK 4	11
TB850940	Pressure jaw circumference	WIN Slotting width 8 - 12	12

Index: Reference number for allocation of the spare parts

Auger Drill HS SPRINT

Application

- For carrying out deep drillings
- Soft and hard woods

Machine

- CNC joinery systems
- Portal machining systems

Design

- Point and face NC ground
- Polished ground flute
- Base body HS solid for longer service life and stability

Your benefits

- Highest quality hole due to HS quality
- Precise holes (low runout) thanks to special drill tip

	Art. No.	Type	D	SL	L	d1	Z	DR
✓	TB700178	SPRINT	5	140	190	5	1 + 1	re.
✓	TB700179	SPRINT	6	140	190	6	1 + 1	re.
✓	TB700180	SPRINT	8	200	250	8	1 + 1	re.
✓	TB700181	SPRINT	10	250	300	10	1 + 1	re.
✓	TB700182	SPRINT	11	250	300	11	1 + 1	re.
✓	TB700183	SPRINT	12	250	300	12	1 + 1	re.
✓	TB700184	SPRINT	13	250	300	13	1 + 1	re.
✓	TB700185	SPRINT	14	250	300	14	1 + 1	re.
✓	TB700186	SPRINT	16	250	300	13	1 + 1	re.
✓	TB700175	SPRINT	17	300	350	13	1 + 1	re.
✓	TB700187	SPRINT	18	250	300	13	1 + 1	re.
✓	TB700188	SPRINT	20	300	350	13	1 + 1	re.
✓	TB700189	SPRINT	22	300	350	13	1 + 1	re.
✓	TB700176	SPRINT	24	300	350	13	1 + 1	re.
✓	TB700190	SPRINT	25	300	350	13	1 + 1	re.
✓	TB700177	SPRINT	26	300	350	13	1 + 1	re.
✓	TB700198	SPRINT	28	300	350	13	1 + 1	re.
✓	TB700191	SPRINT	30	300	350	13	1 + 1	re.
✓	TB700192	SPRINT	32	300	350	13	1 + 1	re.
✓	TB700193	SPRINT	40	300	350	13	1 + 1	re.
✓	TB700194	SPRINT	6	390	460	12 / 6-edges	1 + 1	re.
✓	TB700195	SPRINT	8	390	460	12 / 6-edges	1 + 1	re.
✓	TB700196	SPRINT	10	390	460	12 / 6-edges	1 + 1	re.
✓	TB700197	SPRINT	12	390	460	12 / 6-edges	1 + 1	re.

- ✓ Ex stock, subject to the goods being unsold
- According to frame schedule

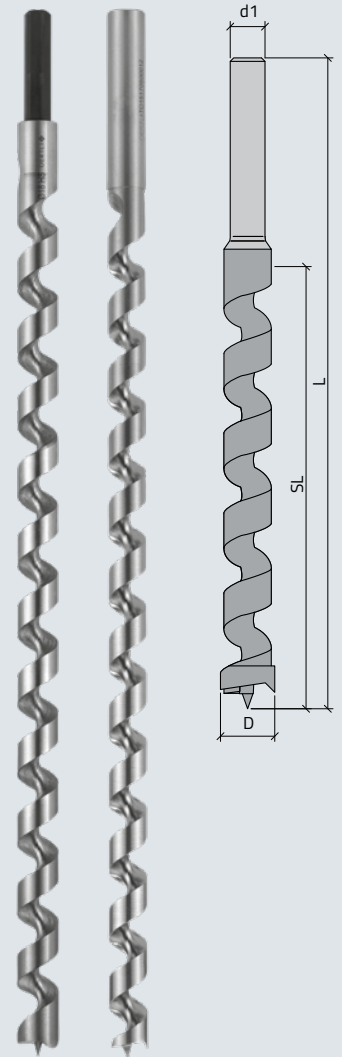

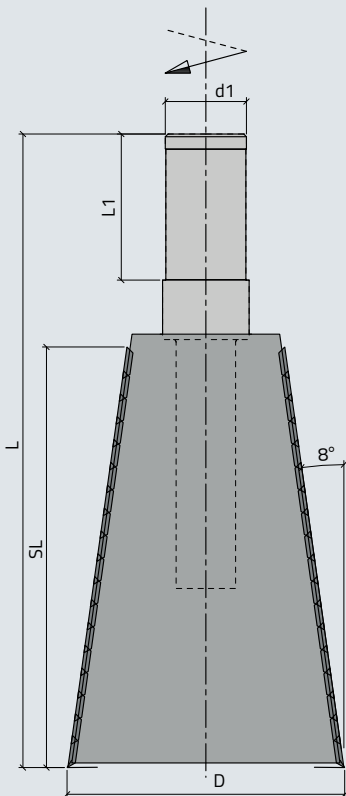

CASTOR Tyrol lock

Application

- Profile milling cutter for the corner joint Tyrolean lock
- Soft and hard woods
- Finishing quality

Machine

- CNC joinery systems

Design

- With standard reversible cutters
- Face cutting edge for rebating
- Base body made of Aluminium, shaft made of steel

Your benefits

- Time saving thanks to top quality no reworking necessary
- Increase in productivity due to higher Feed performance

Art. No.	Type	D	SL	L1	L	d1	Z	DW	DR	n max	Index
• TB860128	Steel/Alu	102	155	60	227	30	Z-Basis 2	neg.	re.	15300	1,4
• TB860129	Steel/Alu	102	155	54	234	30/29.8	Z-Basis 2	neg.	re.	13800	1,4

Spare parts

Art. No.	Detail	Term	Index
KF220017	Cutting edge circumference / face side	13.8 x 13.8 x 2.5	1
TA851040	Screw for KF220017	M5 x 15.5 Torx 15	4

Thermal shrink chuck

Application

- Highest precision at clamping shank tools
- For shank tools with steel and HW shank

Machine

- CNC machining centres
- CNC joinery systems
- Portal machining systems

Design

- Hardened and ground precision design
- Fine balanced for high speeds
- „Heavy-duty design“ for increased clamping force and stability

Your benefits

- Improved surface quality thanks to optimized stability
- Higher feed rates and higher productivity due to improved clamping force
- Processing of thick plates possible due to longer projection lengths

	Art. No.	HSK-Type	Design	D	d	L2	A	n max	Compatible with
✓	TA676792	HSK 63F	lightweight	42	20	49	75	24000	
✓	TB676530	HSK 63F	heavy	42	20	159	185	18000	
✓	TA676793	HSK 63F	lightweight	42	25	49	75	24000	
✓	TB676531	HSK 63F	heavy	53	25	59	85	24000	
✓	TB676532	HSK 63F	heavy	50	25	109	135	18000	
✓	TB676533	HSK 63F	heavy	50	25	159	185	18000	
✓	TB676534	HSK 63F	heavy	53	30	69	95	24000	
✓	TB676539	HSK 63E	lightweight	42	20	54	80	24000	Hundegger/SCM
✓	TB676608	HSK 63E	heavy	46	20	59	85	24000	Hundegger/SCM
✓	TB676540	HSK 63E	lightweight	42	20	149	175	18000	Hundegger/SCM
●	TB676541	HSK 63E	lightweight	42	20	214	240	18000	Hundegger/SCM
✓	TB676538	HSK 63E	heavy	53	25	59	85	24000	Hundegger/SCM
✓	TB676516	HSK 63E	lightweight	53	25	89	115	24000	Hundegger/SCM
✓	TB676537	HSK 63E	heavy	53	30	69	95	24000	Hundegger/SCM
✓	TB676543	HSK 63E	heavy	56	30	119	145	18000	Hundegger/SCM
✓	TB676544	HSK 63E	heavy	56	30	149	175	18000	Hundegger/SCM
✓	TB676545	HSK 63E	heavy	56	30	179	205	18000	Hundegger/SCM
✓	TB676557	HSK 63E	heavy	68	40	109	135	18000	Hundegger/SCM
●	TB676558	HSK 80A	heavy	58	30	69	95	18000	
✓	TB676536	HSK 80A	heavy	60	30	86	112	18000	
●	TB676559	HSK 80A	heavy	58	30	119	145	18000	
●	TB676560	HSK 80A	heavy	58	30	149	175	18000	
●	TB676561	HSK 80A	heavy	58	30	179	205	18000	
●	TB676562	HSK 80A	heavy	68	40	89	115	18000	
✓	TB676585	HSK 80E/C	lightweight	42	20	54	80	24000	Hundegger
✓	TB676586	HSK 80E/C	lightweight	42	20	119	145	18000	Hundegger
●	TB676587	HSK 80E/C	lightweight	42	20	149	175	18000	Hundegger
●	TB676588	HSK 80E/C	lightweight	42	20	179	205	18000	Hundegger

- ✓ Ex stock, subject to the goods being unsold
- According to frame schedule

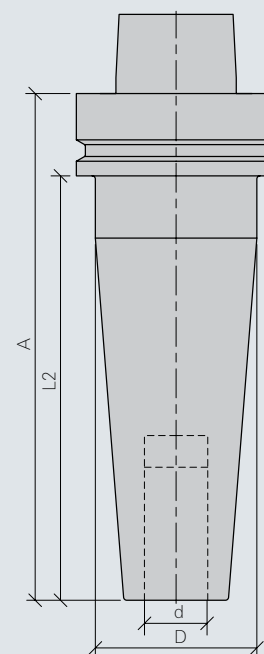

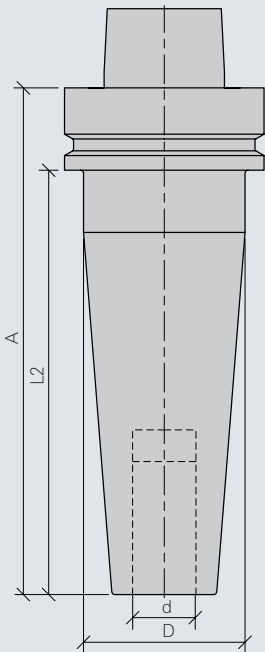

Art. No.	HSK-Type	Design	D	d	L2	A	n max	Compatible with
• TB676589	HSK 80E/C	lightweight	42	20	214	240	18000	Hundegger
✓ TB676590	HSK 80E/C	heavy	53	25	59	85	24000	Hundegger
✓ TB676563	HSK 80E/C	heavy	53	25	94	120	18000	Hundegger
• TB676591	HSK 80E/C	heavy	53	25	119	145	18000	Hundegger
• TB676564	HSK 80E/C	heavy	53	25	134	160	18000	Hundegger
✓ TB676592	HSK 80E/C	heavy	53	25	149	175	18000	Hundegger
✓ TB676593	HSK 80E/C	heavy	53	25	179	205	18000	Hundegger
✓ TB676565	HSK 80E/C	heavy	56	30	69	95	18000	Hundegger
✓ TB676566	HSK 80E/C	heavy	56	30	119	145	18000	Hundegger
• TB676567	HSK 80E/C	heavy	56	30	149	175	18000	Hundegger
✓ TB676568	HSK 80E/C	heavy	56	30	179	205	18000	Hundegger
✓ TB676569	HSK 80E/C	heavy	68	40	89	115	18000	Hundegger
✓ TB676542	HSK 80F	lightweight	42	20	54	80	24000	Technowood
• TB676570	HSK 80F	lightweight	42	20	119	145	18000	Technowood
• TB676521	HSK 80F	lightweight	42	20	134	160	18000	Technowood
• TB676571	HSK 80F	lightweight	42	20	149	175	18000	Technowood
• TB676572	HSK 80F	lightweight	42	20	179	205	18000	Technowood
• TB676573	HSK 80F	lightweight	42	20	214	240	18000	Technowood
✓ TB676574	HSK 80F	heavy	53	25	59	85	24000	Technowood
• TB676522	HSK 80F	lightweight	53	25	94	120	18000	Technowood
✓ TB676575	HSK 80F	heavy	53	25	119	145	18000	Technowood
• TB676523	HSK 80F	lightweight	53	25	134	160	18000	Technowood
✓ TB676576	HSK 80F	heavy	53	25	149	175	18000	Technowood
✓ TB676577	HSK 80F	heavy	53	25	179	205	18000	Technowood
✓ TB676546	HSK 80F	heavy	56	30	69	95	24000	Technowood
✓ TB676535	HSK 80F	heavy	60	30	86	112	18000	Technowood
✓ TB676547	HSK 80F	heavy	56	30	119	145	18000	Technowood
✓ TB676548	HSK 80F	heavy	56	30	149	175	18000	Technowood
✓ TB676549	HSK 80F	heavy	56	30	179	205	18000	Technowood
✓ TB676550	HSK 80F	heavy	68	40	89	115	18000	Technowood
✓ TB676578	HSK 85S	lightweight	42	20	57	90	24000	SCM
✓ TB676579	HSK 85S	lightweight	42	20	112	145	18000	SCM
• TB676580	HSK 85S	lightweight	42	20	142	175	18000	SCM
• TB676581	HSK 85S	lightweight	42	20	172	205	18000	SCM
• TB676582	HSK 85S	lightweight	42	20	207	240	18000	SCM
✓ TB676583	HSK 85S	heavy	53	25	62	95	24000	SCM
• TB676551	HSK 85S	heavy	53	25	112	145	18000	SCM
• TB676552	HSK 85S	heavy	53	25	142	175	18000	SCM
• TB676584	HSK 85S	heavy	53	25	172	205	18000	SCM
✓ TB676553	HSK 85S	heavy	56	30	72	105	24000	SCM
• TB676554	HSK 85S	heavy	56	30	112	145	18000	SCM
• TB676555	HSK 85S	heavy	56	30	142	175	18000	SCM

Art. No.	HSK-Type	Design	D	d	L2	A	n max	Compatible with
✓ TB676556	HSK 85S	heavy	56	30	172	205	18000	SCM
✓ TB676594	HSK 100A	lightweight	42	20	56	85	18000	Uniteam
✓ TB676595	HSK 100A	lightweight	42	20	116	145	18000	Uniteam
✓ TB676596	HSK 100A	lightweight	42	20	146	175	18000	Uniteam
● TB676597	HSK 100A	lightweight	42	20	176	205	18000	Uniteam
● TB676598	HSK 100A	lightweight	42	20	211	240	18000	Uniteam
✓ TB676599	HSK 100A	heavy	53	25	61	90	18000	Uniteam
✓ TB676600	HSK 100A	heavy	53	25	116	145	18000	Uniteam
✓ TB676601	HSK 100A	heavy	53	25	146	175	18000	Uniteam
✓ TB676602	HSK 100A	heavy	53	25	176	205	18000	Uniteam
✓ TB676603	HSK 100A	heavy	56	30	71	100	18000	Uniteam
✓ TB676604	HSK 100A	heavy	56	30	116	145	18000	Uniteam
● TB676605	HSK 100A	heavy	56	30	146	175	18000	Uniteam
✓ TB676606	HSK 100A	heavy	56	30	176	205	12000	Uniteam
✓ TB676607	HSK 100A	heavy	68	40	91	120	18000	Uniteam

Collet chuck

Application

- For clamping shank tools
- For shank tools with steel and HW shank

Machine

- CNC machining centres
- CNC joinery systems
- Portal machining systems

Design

- Hardened and ground precision design
- Balanced for high speeds
- Collet chuck with slide ring or ball bearing
- Chuck for increased clamping force and Precision

Your benefits

- Universal chuck
- Clamping range d 3–30 mm

Art. No.	HSK-Type	Type	D	d	A	n max	Compatible with
✓ TB676900	HSK 63F	ER 40	63	3-30	95	24000	
✓ TB676903	HSK 63E	ER 40	63	3-30	78	24000	SCM/Hundegger
✓ TB676904	HSK 80E/C	ER 40	63	3-30	95	24000	Hundegger
✓ TB676901	HSK 80F	ER 40	63	3-30	95	24000	Technowood
✓ TB676905	HSK 85S	ER 40	63	3-30	95	24000	SCM
✓ TB676906	HSK 100A	ER 40	63	3-30	95	24000	Uniteam

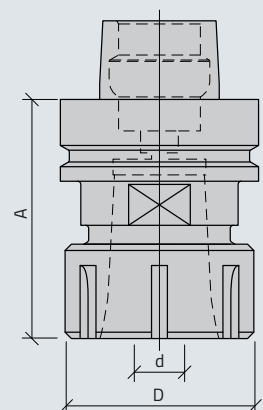

✓ Ex stock, subject to the goods being unsold
● According to frame schedule

Collet ER 40

Application

- For clamping shank tools
- For shank tools with steel shank

Machine

- For collet chucks and milling units with 8° cone

Design

- Hardened and ground precision design
- Double slotted for high clamping force and true running accuracy

Your benefits

- Universal chuck
- Clamping range d 3–30 mm

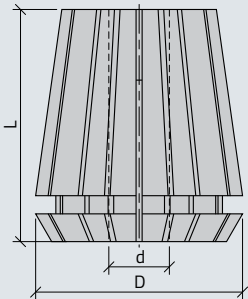

	Art. No.	d	D	L
✓	TA676995	3	41	46
✓	TA676910	4	41	46
✓	TA676912	6	41	46
✓	TA676914	8	41	46
✓	TA676916	10	41	46
✓	TA676918	12	41	46
✓	TA676923	14	41	46
✓	TA676920	16	41	46
✓	TA676924	18	41	46
✓	TA676921	20	41	46
✓	TA676922	25	41	46
✓	TB677009*	30	41	46

* Suitable for shaft with offset D 30/29.4 – 29.8 mm

HSK Clamping shaft

Application

- For clamping single or set tools
- For clamping tools with bore

Machine

- CNC machining centres
- CNC joinery systems
- Portal machining systems

Design

- Hardened and ground precision design
- Balanced for high speeds
- With anti-rotation device suitable for OERTLI tools

Your benefits

- Mounting and A-dimension adapted to the machine
- High true running accuracy
- Independent of direction of rotation

	Art. No.	HSK-Type	d	A	L1	L2	Compatible with
✓	TB200020	HSK 63E	35	46	92.5	149	SCM/Hundegger
✓	TB200021	HSK 63E	35	46	114.5	171	SCM/Hundegger
✓	TB200022	HSK 63E	35	46	142.5	199	SCM/Hundegger
✓	TB200023	HSK 63E	35	46	169.5	226	SCM/Hundegger
✓	TB200024	HSK 63E	35	46	196.5	253	SCM/Hundegger
✓	TB200025	HSK 63E	35	46	219.5	276	SCM/Hundegger
✓	TB200026	HSK 63E	35	46	243.5	300	SCM/Hundegger
✓	TB200056	HSK 80E/C	50	40	140	195	Hundegger
✓	TB200057	HSK 80E/C	50	40	210	265	Hundegger
✓	TB200058	HSK 80E/C	50	40	275	330	Hundegger
✓	TB200059	HSK 80F	50	40	140	195	Technowood
✓	TB200060	HSK 80F	50	40	210	265	Technowood
✓	TB200061	HSK 80F	50	40	275	330	Technowood
✓	TB200065	HSK 85S	35	40	140	190	SCM
✓	TB200066	HSK 85S	35	40	210	260	SCM
●	TB200067	HSK 85S	35	40	275	325	SCM
✓	TB200062	HSK 100A	50	40	140	195	Uniteam
✓	TB200063	HSK 100A	50	40	210	265	Uniteam
✓	TB200064	HSK 100A	50	40	275	330	Uniteam

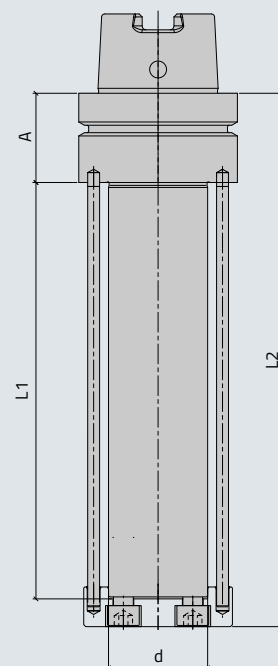

✓ Ex stock, subject to the goods being unsold
 ● According to frame schedule

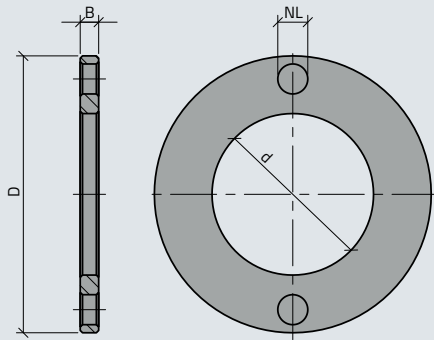

Spacer

	Art.Nr.	Type	D	d	B	NL
✓	TA629594	Steel	60	35	0.05	2/6.5/50
✓	TA629596	Steel	60	35	0.1	2/6.5/50
✓	TA629598	Steel	60	35	0.2	2/6.5/50
✓	TA629600	Steel	60	35	0.5	2/6.5/50
✓	TA629602	Steel	60	35	1	2/6.5/50
✓	TB100066	Steel	60	35	3	2/6.5/50
✓	TB100067	Steel	60	35	4	2/6.5/50
✓	TA629612	Steel	60	35	5	2/6.5/50
✓	TB100068	Steel	60	35	8	2/6.5/50
✓	TB100079	Alu	60	35	10	2/6.5/50
✓	TB100069	Alu	60	35	15	2/6.5/50
✓	TA629640	Alu	60	35	20	2/6.5/50
✓	TB100070	Alu	60	35	34	2/6.5/50
✓	TB100071	Alu	60	35	40	2/6.5/50
✓	TB100072	Alu	60	35	60	2/6.5/50
✓	TB100073	Alu	60	35	90	2/6.5/50
✓	TA630158	Steel	75	50	0.05	6/7/65
✓	TA630160	Steel	75	50	0.1	6/7/65
✓	TA630162	Steel	75	50	0.2	6/7/65
✓	TA630164	Steel	75	50	0.5	6/7/65
✓	TA630166	Steel	75	50	1	6/7/65
✓	TA630177	Steel	75	50	5	6/7/65
✓	TA630186	Steel	75	50	10	6/7/65
✓	TA630196	Steel	75	50	20	6/7/65
✓	TA630206	Steel	75	50	30	6/7/65
✓	TB100082	Alu	75	50	60	6/7/65
✓	TB100083	Alu	75	50	90	6/7/65

Saw flanges

Application

- Clamping flange for mounting of circular saws

Machine

- CNC machining centres
- CNC joinery systems
- Portal machining systems

Design

- Hardened and ground precision design
- Balanced for high speeds
- With side holes suitable for OERTLI circular saw blades
- Chemical nickel plating

Your benefits

- Mounting and A-dimension adapted to your system
- High radial and axial runout accuracy

	Art. No.	HSK-Type	d	NL	D	A	Compatible with
●	TB100220	HSK 63F	30	6/M8/75	90	80	
✓	TB100221	HSK 63F	30	6/M8/100	120	80	
●	TB100222	HSK 63F	30	6/M8/140	160	60	
●	TB100223	HSK 63F	30	8/M8/120 + 8/M8/160	180	70	
✓	TB100224	HSK 63E	30	8/M8/120 + 8/M8/160	180	70	
✓	TB100225	HSK 80E/C	30	8/M8/120 + 8/M8/160	180	70	Hundegger
✓	TB100208	HSK 80F	30	8/M8/120 + 8/M8/160	180	70	Technowood
●	TB100226	HSK 85S	30	8/M8/120 + 8/M8/160	180	70	SCM
✓	TB100227	HSK 100A	30	8/M8/120 + 8/M8/160	180	70	Uniteam

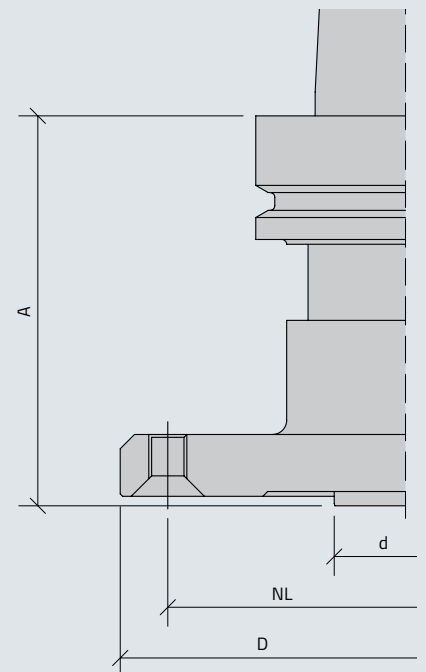
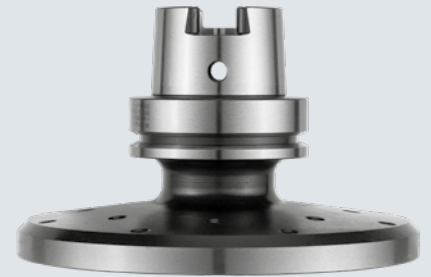

- ✓ Ex stock, subject to the goods being unsold
- According to frame schedule

Technical details

Dimensions for special CASTOR birdsmouth cutter

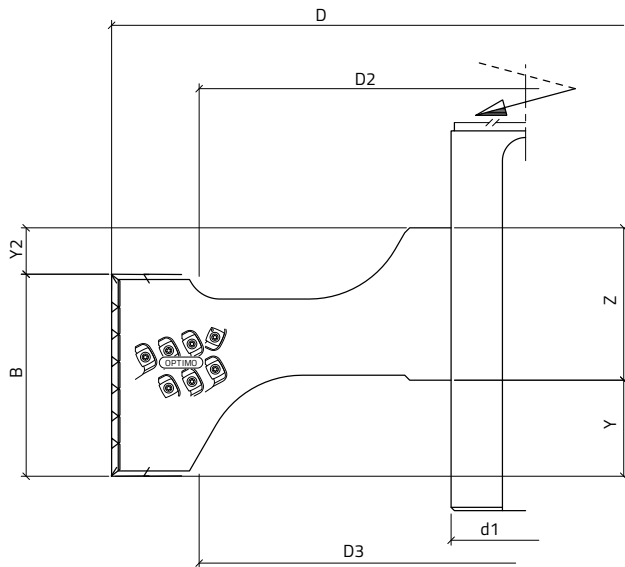

For special birdsouth cutter at Hundegger machines

At K2/K2i/K2 industry

Z=46, independent of the cutting width

Y=29, independent of the cutting width

DKN yes/no

DR= right/left

Additional work

Dimensions for side holes saw blade

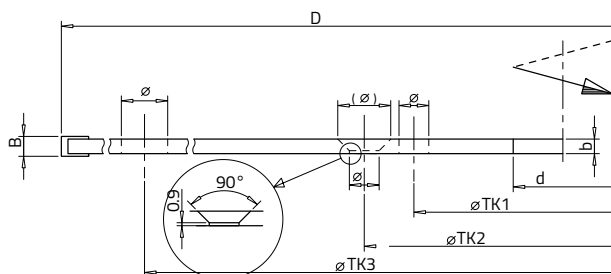

Side holes for saws

Anzahl	Type
2	NL without recess
4	NL without recess
6	NL without recess
8	NL without recess
2	NL with recess
4	NL with recess
6	NL with recess
8	NL with recess

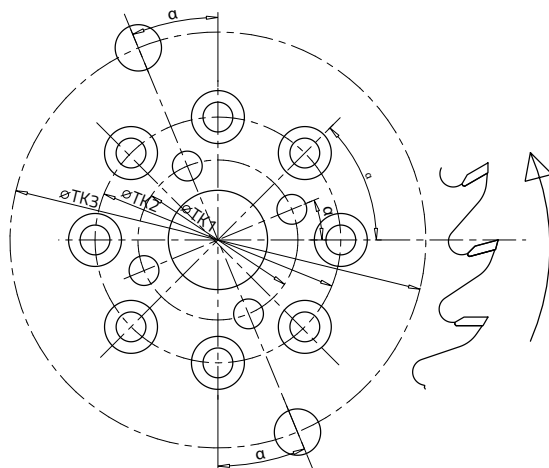

Fitting and mounting of clamping device and tool

Activity	Shank tool assembled with thermoshrink chuck	Boring tool assembled out on clamping shaft with DR set
DR Set		x
Fitting + assembly or shrinking	x	x
Balancing	x	x
Engineering (shaft break-age calculation etc.)	x	x

Tool documentation

Art. No.	Quantity	Activity
YA900374	1	Tool documentation consisting of: 1 drawing folder with tool drawings incl. create PDF file
YA900375	Quantity	Fitting Drawing/Tool

ATTENTION: Indicate weight restrictions

Abbreviation

A	Dimension A on clamping shafts	DR	Direction of rotation	NUL	Working length
alpha	Angle	DW	Spiral slope	POS	Positive spiral angle
B	Cutting width	FZ	Flat tip	R	Radius
b	Saw plate thickness	L	Length	re.	Clockwise rotation
B1	Tool body width	L1	Clamping length	SG	Cutting geometry
D	Diameter	L2	Clamping length shaft	SL	Cutting length
d	Bore	L3	Chamfer width	TK	Pitch circle
D max	Maximum Diameter	li.	Counter clockwise rotation	T max	Maximal grooving depth
D1	Tool body diameter	M	Thread	Type	Various information
d1	Shank diameter	n max	Maximum speed	WZ	Alternating tooth
d2	Ball bearing diameter	NEG	Negative spiral angle	Z	Number of teeth
DKN	Double keyways	NL	Pin holes		

OERTLI Werkzeuge AG

CH-8181 Höri
T +41 44 863 75 11
info@oertli.ch

OERTLI gereedschappenfabriek bv

NL-4902 TT Oosterhout
T +31 162 51 48 80
oertli@oertli.nl

OERTLI Werkzeuge GmbH

A-6800 Feldkirch
T +43 5522 75 78 70
info@oertli.at

**OERTLI Werkzeug- und
Maschinenhandels-GmbH**

D-73486 Adelmansfelden
T +49 7963 84 19 00
info@oertli-werkzeuge.de

OERTLI Magyarország KFT

H-8900 Zalaegerszeg
T +36 92 33 40 81
info@oertlikft.hu

OERTLI Tooling UK Ltd

LE19 4SA Leicester
T +44 116 286 34 09
info@oertli.co.uk

OERTLI France

F-21000 Dijon
T +33 3 80 55 16 62
info@oertli-outils.fr

www.oertli.com